



SERVICE PARTS LIST

BUL. 54-12-1020

1/2" ELECTRIC DRILL

REVISED BUL 662-1 DATE FEB. '68

MODEL NO. C-122

Starting Serial No. **62-1001**

WIRING INSTR.

Both Model and Serial No. must be furnished to obtain correct parts.

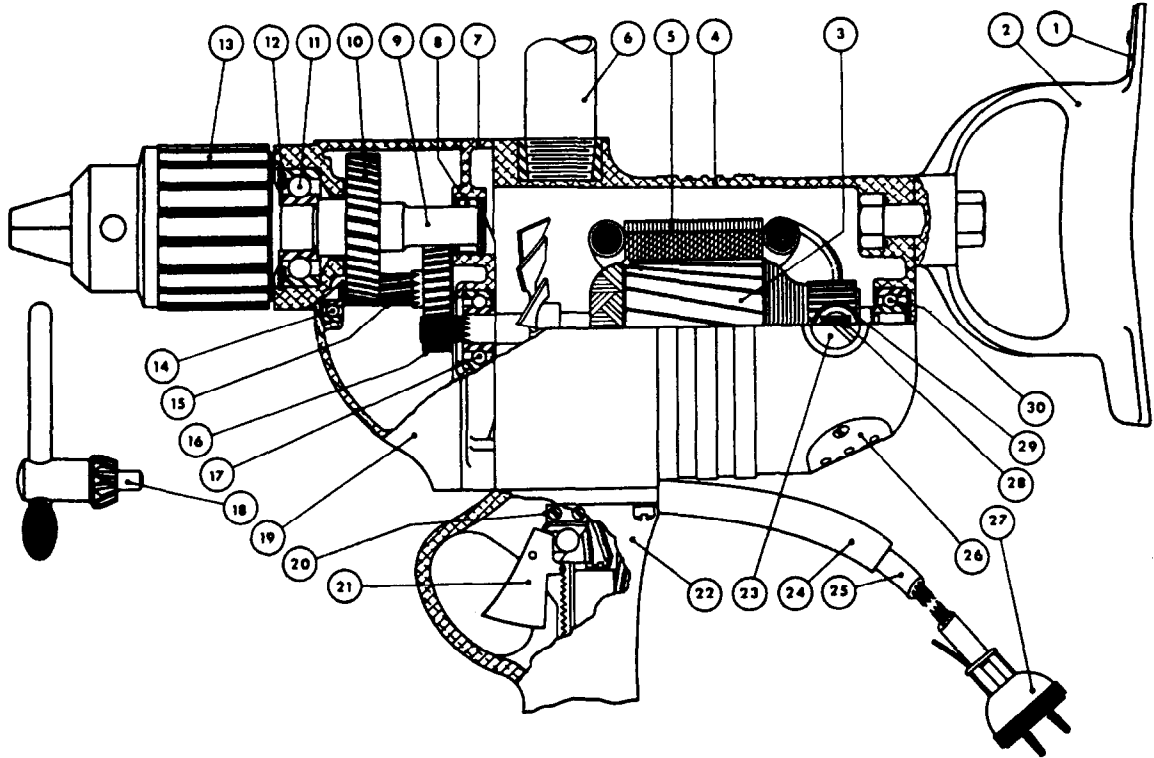

Fig. Part No.	Name of Part
1	88D1-6 Spade Handle Key Clip
2	88D1-3A Spade Handle
3	2C-600A Armature Assembly
4	23D-1 Body or Motor Housing
5	12N-700A Field Assembly
6	88D-43 Pipe Handle
7	2D-2 Diaphragm
8	MH-1081 Spindle Needle Bearing
9	5CK-8A Spindle
10	7CK-11A Spindle Gear
11	ND8603 Spindle Ball Bearing
12	RR-185 Spindle Ball Brg. Retaining Ring
13	1/2" Chuck (5/8"-16 Thread)
14	ND7039 Inter. Shaft Ball Bearing
15	5CK-13A Intermediate Shaft

Fig. Part No.	Name of Part
16	2C-14 Intermediate Gear
17	WC8501 Armature Ball Brg. (Pinion End)
18	1/2" Chuck Key
19	2D-3 Gear Case
20	88D-23 Switch Bracket
21	CH8636K1 Switch
22	88D1-1A Switch Handle
23	88D-400 Brush Retaining Screw Ass'y.
24	88D-48 Cord Protector Tube
25	S#16-3 Cord (3-Wire) (per ft.)
26	23D-41 Air Intake Cover Plate
27	2 Prong Attachment Plug
28	88D-370 Carbon Brush Assemblies (per set 2)
29	88D-320 Brush Holder Assembly
30	ND8500 Armature Ball Bearing (Comm.End)

MISCELLANEOUS PARTS (NOT SHOWN)

Size or Part No.	Description of Part	Size or Part No.	Description of Part
MH681	Inter. Shaft Needle Bearing	1/4"-20x1" Fil. Hd.	Gear Case Screws (2)
C-122	Name Plate	1/4"-20x1-3/4" Fil.Hd.	Gear Case Screws (2)
1/2-13x1-1/2"Hex.Hd.	Spade Handle Bolt (1)	8-32x2-1/2" Rd. Hd.	Field Screws (2)
1/2"-13	Spade Handle Jam Nut (1)	1/4"-20x3/4" Fil. Hd.	Switch Handle Screws (4)
#4x5/16" Driv-In	Spade Handle Key Clip Screw (1)	1/4"-20x1/2" H'dless	Brush Holder Set Screws (2)
6-32x1/4" Rd. Hd.	Switch Mounting Screws (2)	#8	Kantlink Lock Washers (2)
6-32x1/4" Fil.Hd.	Switch Bracket Screws (2)	#14	Kantlink Lock Washers (10)
#4x5/16" Driv-In	Name Plate Screws (2)	#2	Woodruff Keys (1)
#6x1/4" P.K.	Air Intake Plate Screws (2)	#3	Woodruff Keys (2)

Prices are subject to change without notice