



Power Tool Division
Rockwell International

1450, 34-405, 34-450, 34-460,
34-461, 34-466
10" TILTING ARBOR UNISAW

CS-4K
422-04-651-5003
Revised 1-10-75



** WHEN REPLACING THE BEARINGS USED IN THE ARBOR BRACKET ASSEMBLY, THE CUSTOMER MUST ORDER THE PROPER BEARING. MOST OLDER MODELS OF THE UNISAW USE THE SP-5344, BEARING, WITH EXTENDED INNER RING. NEWER MODELS USE THE SP-5335, BEARING. SPACER, LTA-412 MUST BE USED WITH BEARING SP-5344. SPACER, 422-04-104-0002 MUST BE USED WITH BEARING SP-5335.

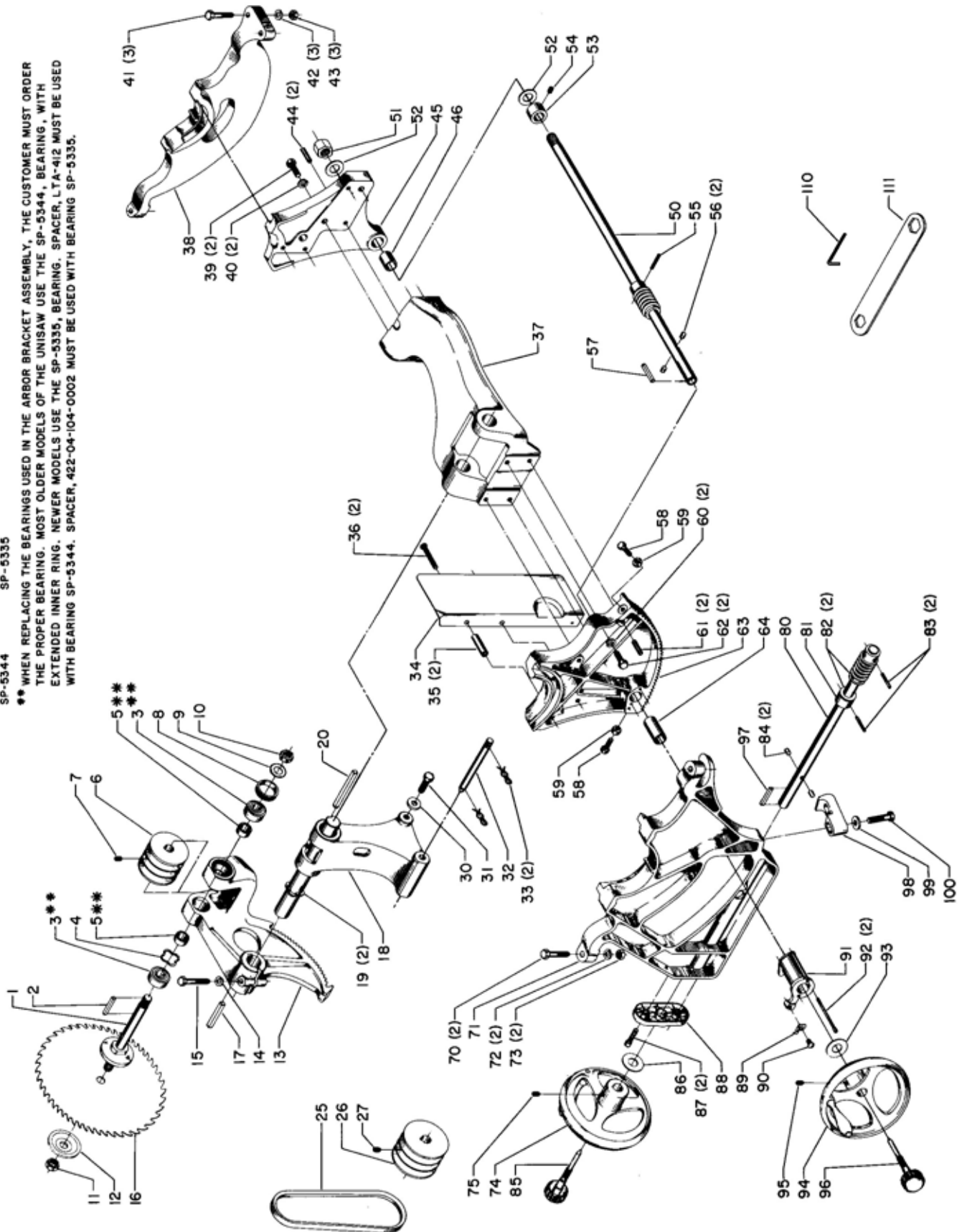

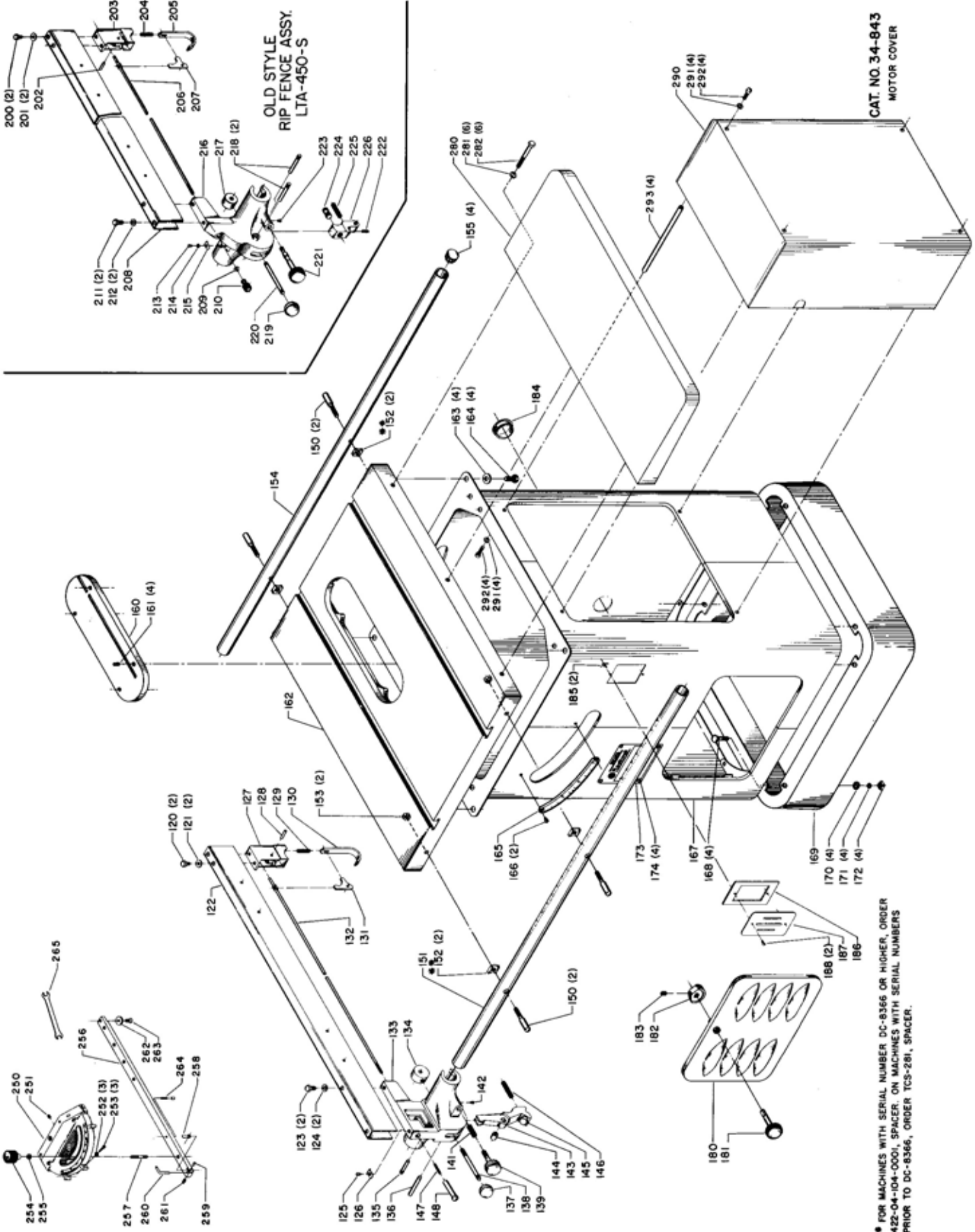

•• FOR MACHINES WITH SERIAL NUMBER DC-8366 OR HIGHER, ORDER 422-04-104-0001, SPACER, ON MACHINES WITH SERIAL NUMBERS PRIOR TO DC-8366, ORDER TCS-281, SPACER.