

**POWERMATIC®**

MODEL  
**143**

OPERATING INSTRUCTIONS

**BAND SAW**

# OPERATING INSTRUCTIONS

**AND**

**PARTS LIST**

*94-96" Blade  
7'10"-8'0"*

**FOR SERIAL NUMBERS FROM 1-101 UP**

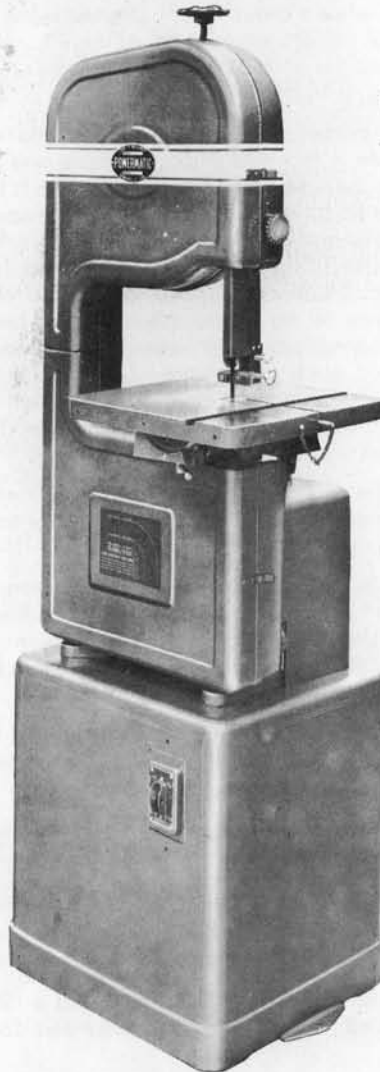

**POWERMATIC**  **HOUDAILLE, INC.**

McMinnville, Tennessee 37110

*WMH Tool Group -  
1-800-274-6848*

*N.W. Powertools  
1-877-495-8665*

*Powermatic  
1-800-248-0144*

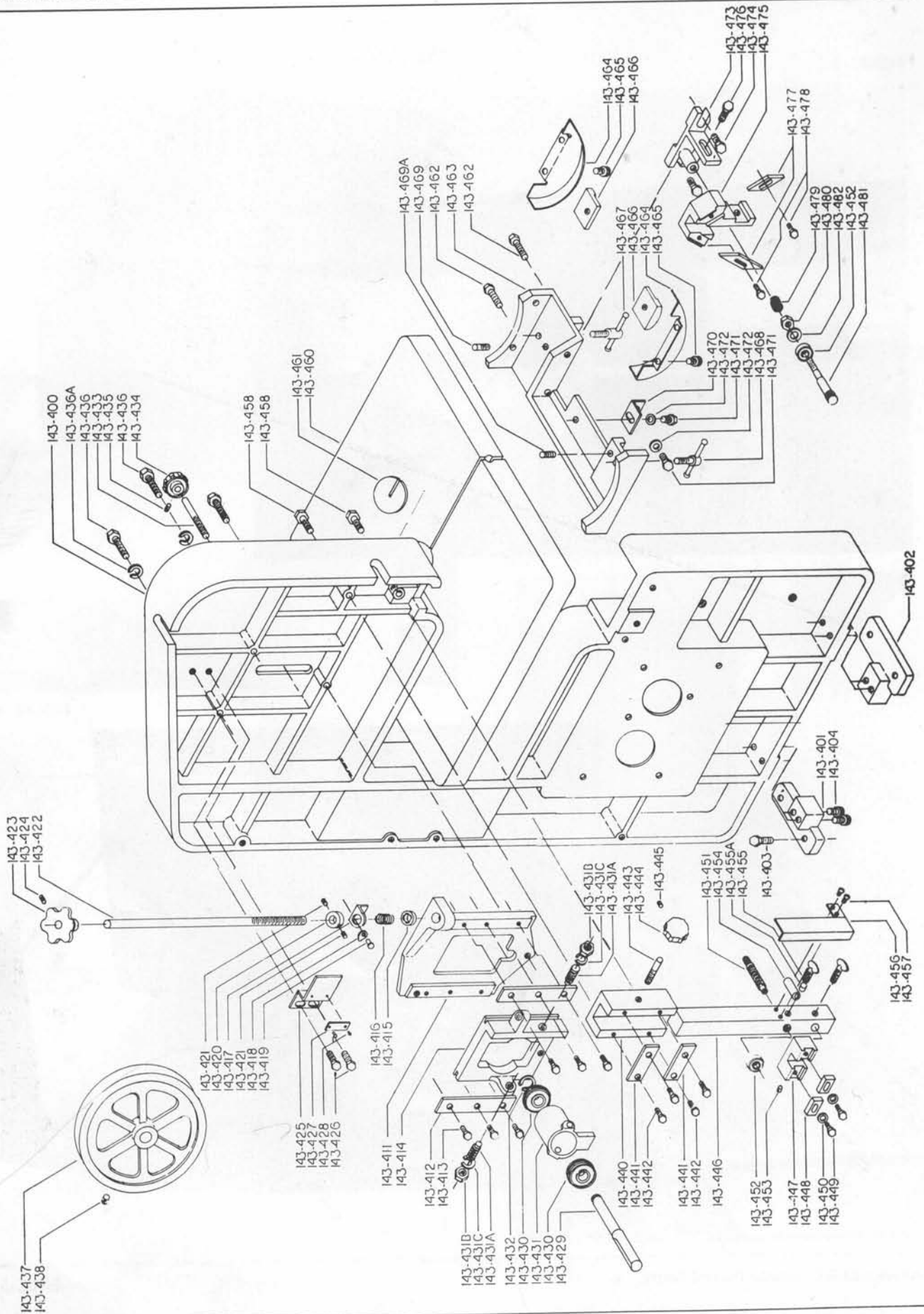

**MODEL 143-14" METAL BAND SAW**

Part No.	Description	Quantity Required	Part No.	Description	Quantity Required
400	Frame	1	446	Guide Bar	1
401	Leg, Frame, Left	1	447	Upper Guide Holder	1
402	Leg, Frame, Right	1	448	Upper Guide	2
403	Bolt, Stand Mounting (Not Pic) 3/8-16 x 1-1/4 Hex Hd.	4	449	Screw, Guide Mounting 1/4-20 x 3/4 Hex Hd	2
403A	Lock Washer (Not Pic)	4	450	Washer, Guide Mounting Screw	2
404	Bolt, Leg Mounting 3/8-16 x 1" Socket Hd.	4	451	Shaft, Upper Guide Back-Up Bearing	1
405	Stand	1	451A	Knob, Bearing Shaft	1
405A	Leg Support 3/8 x 1-1/2 HRS x 16" Lg.	2	452	Bearing, Back-Up Upper & Lower N.D. 3200 or Eq.	2
406	Door, Upper (Not Pic)	1	453	Setscrew, Upper Guide Holder 5/16-18 x 5/16	1
407	Door, Lower (Not Pic)	1	454	Pin, For Upper Guide	1
408	Cover, Lower Drive	1	455	Wing Screw, Guide Bar 5/16-18 x 1"	2
409	Chain, Cover Mounting	1	456	Guard, Saw	1
409A	Screw, Chain Mounting 8-32 x 1/2	2	457	Screw, Saw Guard Mounting 1/4-20 x 1/2 Hex Hd.	2
410	Hinge, Cover Mounting	1	458	Bolt, Guide Bar Holder Mounting 3/8-16 x 1-3/4 Hex Hd.	2
410A	Screw, Hinge Mounting 5/16-18 x 1/2	3	459	Lock Washer	2
411	Mounting Bracket, Upper Bearing Housing Bracket	1	460	Table	1
412	Shim, Slide Bracket	2	461	Insert, Table	1
413	Screw, Shim Mounting 5/16-18 x 1" Button Hd.	6	462	Bolt, Trunion Bracket Mounting 5/16-18 x 1-1/4 Socket Hd.	2
414	Bracket, Upper Bearing Housing	1	463	Trunion Bracket	1
415	Pressure Bearing, Tension Adj. Screw	1	464	Trunion	2
416	Spring, Tension Adj. Screw	1	465	Bolt, Trunion Mounting 5/16-18 x 3/4 Socket Hd.	4
417	Clip, Spring	1	466	Bracket, Trunion Clamp	2
418	Pointer, Tension Adj.	1	467	Lockscrew, Trunion Clamp Bracket (Long)	1
419	Screw, Pointer Mounting 6-32 x 1/4	1	468	Lockscrew, Trunion Clamp Bracket (Short)	1
420	Collar, Tension Adj. Screw	1	469	Stud, Trunion Clamp Bracket Leveling (Long)	1
421	Setscrew, Collar 4/16-18 x 1/4	1	469A	Stud, Trunion Clamp Bracket Leveling (Short)	1
422	Screw, Tension Adj.	1	470	Clip, Trunion Bracket Support	1
423	Handle, Tension Adj. Screw	1	471	Bolt, Clip Mounting 5/16-18 x 1/2 Hex Hd.	2
424	Setscrew, Tension Adj. Screw Handle 5/16-18 x 1/4	1	472	Washer, Mounting Bolt	2
425	Bracket, Tension Adj. Scale	1	473	Bracket, Lower Guide Holder Mounting	1
426	Bolt, Bracket Mounting 5/16-18 x 1/2 Hex Hd	2	474	Bolt, Bracket Mounting 5/16-18 x 1-1/4 Hex Hd.	2
427	Scale, Tension Adj.	1	475	Holder, Lower Guide	1
428	Screw, Scale Mounting 6-32 x 1/4	2	476	Bolt, Holder Mounting 5/16-18 x 3/4 Hex Hd	1
429	Shaft, Upper Wheel	1	476A	Washer, Mounting Bolt	1
430	Bearing, Upper Wheel Shaft FAFNIR 203 NPPG OR EQUAL	2	477	Lower Guide	2
431	Bearing Housing, Upper Wheel Shaft	1	478	Screw, Lower Guide Mounting 1/4-20 x 3/4 Hex Hd.	2
431A	Setscrew, Bearing Housing Mounting 1/2-13 x 1/4 DP	2	479	Spring, Lower Back-Up Bearing	1
431B	Nut, Setscrew Locking 1/2-13 Hex Hd.	2	481	Shaft, Lower Backup Bearing	1
432	Lock Ring, Wheel Shaft 5100-66 Tru-Arc Waldes	1	488	Bolt, Transmission Mounting 5/16-18 x 2" Hex Hd.	4
433	Screw, Wheel Tilting	1	492	Motor	1
434	Handle, Tilting Screw	1	493	Bolt, Motor Mounting 5/16-18 x 1" Hex Hd	4
435	Setscrew, Handle 1/4-20 x 1/4	1	494	Plate, Motor Mounting	1
436	Bolt, Mounting Bracket 3/8-16 x 1-1/2 Hex	3	496	Screw, Cover Lock	1
436A	Lock Washer	3	497	Handle, Lock Screw	1
437	Wheel, Upper and Lower	2	498	Setscrew, Handle 5/16-18 x 1/4	1
438	Setscrew, Wheel 5/16-18 x 3/8	2	500	Bearing Housing, Countershaft	1
440	Holder, Guide Bar	1	501	Bearing, Countershaft MRC 204 SZZG or Equal	2
441	Plate, Guide Bar Holder	2			
442	Screw, Plate Mounting	4			
443	Screw, Guide Bar Locking	1			
444	Handle, Locking Screw	1			
445	Setscrew, Handle 1/4-20 x 1/4	1			

3289013

Part No.	Description	Quantity Required	Part No.	Description	Quantity Required
502	Countershaft	1	533	Bearing, FAFNIR 303 PP or Equal	3
504	Key, Countershaft	1	535	Wheel Shaft	1
505	Spacer, Lock Screw	1	536	Gear, High Speed	1
506	Lockscrew, Countershaft Bearing Housing	1	537	Setscrew, 5/16-18 x 1/2	1
507	Bolt, Countershaft Bearing Housing 1/2-13 x 1-1/4 Hex	1	538	Key, #606 Woodruff	2
507A	Nut 1/2-13 Hex	1	539	Gear, Low Speed Idler	1
508	Pulley, Countershaft Drive (Browning AK 74)	1	540	Bushing, PS 1000-32A Johnson	1
509	Setscrew, Pulley 5/16-18 x 5/16	2	541	Gear, Low Speed Main	1
510	Pulley, Step Cone, Countershaft (Browning SCE6)	1	542	Main Shaft	1
511	Gear Box	1	545	Bearing Cap, Gear Box w/Hole	1
512	Top, Gear Box	1	546	Gasket, Bearing Cap	3
513	Gasket, Gear Box	1	547	Bearing Cap, Gear Box	2
514	Bolt, Top Mounting 5/16-18 x 1" Hex Hd	6	548	Screw, Bearing Cap Mounting 1/4-20 x 3/8 Hex Hd	9
515	Pin, Top Aligning 1/4 x 3/4 Split Pin	2	550	Pulley, Step Cone, Main Shaft	1
516	Plug, Vent, Gear Box	1	551	Setscrew, Pulley 5/16-18 x 5/16	1
517	Plug, Drain, Gear Box	1	552	Belt, Step Cone Pulley 4L510 Browning	1
518	Ell, Oil, Gear Box	1	554	Clutch Fork	1
519	Plug, Ell	1	555	Pin, Clutch Fork	2
520	Bearing, N.D. Z99AE0120 or Equal	1	556	Screw, Clutch Fork Locking 5/16-18 x 1" Flat Hd	1
520A	Lock Ring, Bearing 5002-185 Tru-Arc Waldes	1	556A	Lock Washer	1
521	Spacer, Wheel Shaft	1	557	Shaft, Clutch Fork	1
522	Lock Ring, TRB 1220	4	558	Handle, Clutch Fork	1
523	Gear, High Speed Clutch	1	559	Setscrew, Clutch Shaft Handle 5/16-18 x 3/8	1
524	Bushing, PS 1000-64 Johnson	2	560	Plunger, Clutch Shaft Handle	1
525	Bearing, Torrington IR 1216	3	561	Spring, Plunger	1
526	Clutch	1	562	Nut, Shaft Handle Plunger	1
527	Gear, Low Speed Clutch	1	563	Knob, Plunger	1
528	Bearing, Torrington IR 1212	3	564	Collar, Clutch Shaft Lock	1
529	Bushing, PS 1000-48A Johnson	1	565	Setscrew, Lock Collar 5/16-18 x 5/16	1
530	Gear, First Idler	1	566	Washer, Clutch Shaft, Nylatron	2
531	Gear, Second Idler	2	570	Oil Instruction Plack (Not Pic)	1
532	Spacer, Wheel Shaft	1	571	Range Sticker (Not Pic)	1

**FILING ATTACHMENT**

585	Guide Bar	1	592	Lock Washer	2
586	Upper Holder	1	593	Setscrew 5/16-18	3
587	Shaft, Mounting	2	594	Thumb Screw 5/16-18	1
588	Swivel Bracket	1	595	Holddown Roller	1
589	Holddown, Fileband	1	596	Screw, Roller Mounting 1/4-20-NC x 1-1/4	1
590	Lower Holder	1	597	Lock Nut 1/4-20-NC	1
591	Screw, Guide Bar Mounting 10-24 NC x 1/2 Lg	2	598	Washer	2
			599	Setscrew 1/4-20	1

