



# SERVICE PARTS LIST

BUL. 54-08-2222

## 1/2" ELECTRIC DRILL

REVISED BUL 6134-3 DATE Feb. '68  
WIRING INSTR.

Catalog No. 1200-1

Starting Serial No. 134-2639

Both Model and Serial No. must be furnished to obtain correct parts.

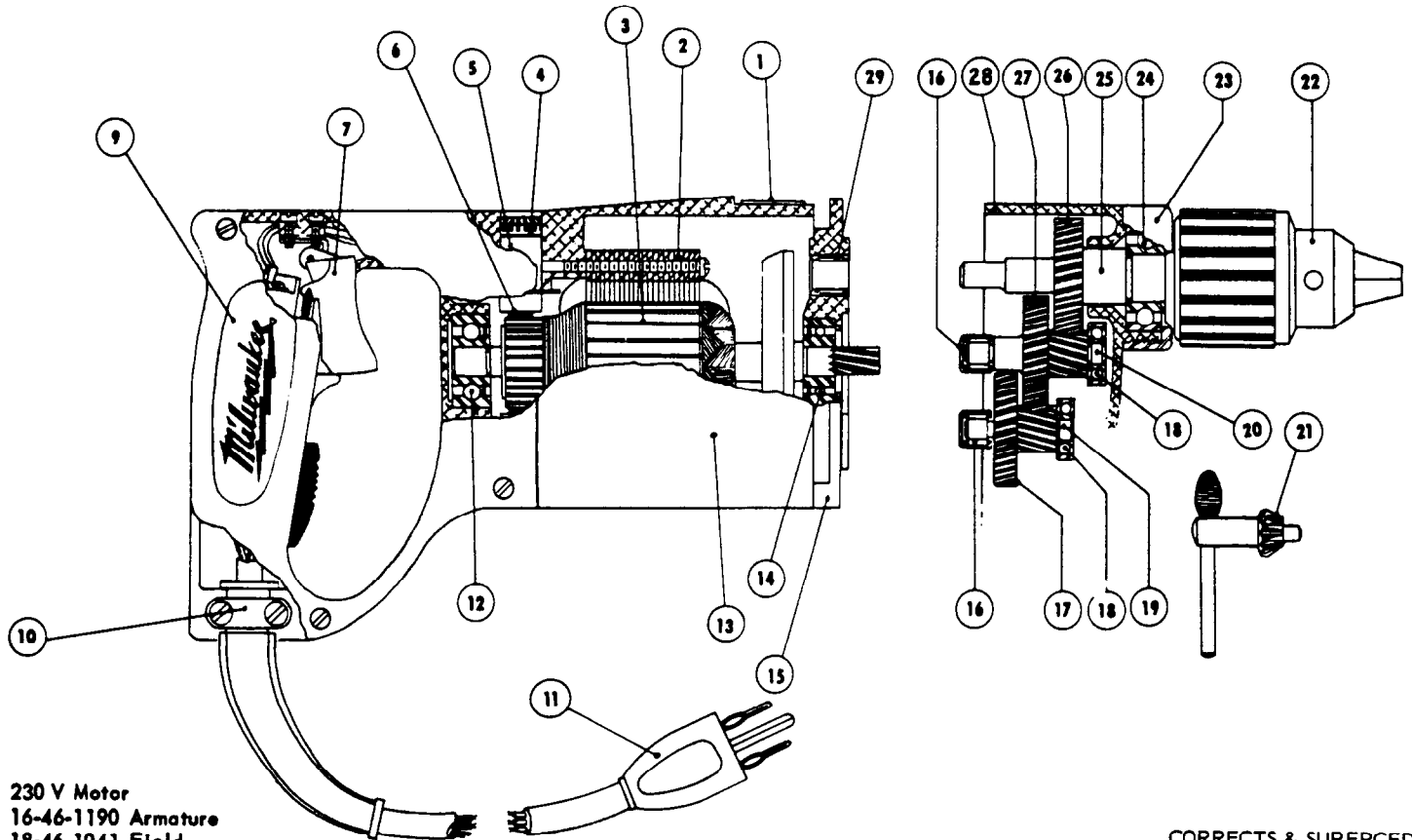

230 V Motor  
16-46-1190 Armature  
18-46-1041 Field

CORRECTS & SUPERCEDES  
SERVICE BULLETIN 6134-3  
DATED 10/10/62

FIG.	PART NO.	DESCRIPTION OF PART
	1	12-98-0800 Name Plate
*	2	18-42-1141 Field Assembly
	3	16-42-1210 Armature Assembly
	4	23-44-0060 Brush Retaining Screw
	5	22-22-0080 Brush Holder Assembly
	6	22-18-0100 Carbon Brush Assembly
*	7	23-66-0485 Switch
*	9	28-20-3601 Handle Cover
	10	28-17-0400 Cord Clamp Strap
	11	22-64-0170 Cord Set
	12	02-04-0970 Ball Bearing (Comm. End)
	13	28-50-4488 Motor Housing
	14	02-04-0940 Ball Bearing (Pinion End)
	15	28-28-0661 Diaphragm
	16	02-50-1640 Ball Bearing

### ILLUSTRATED PARTS

FIG.	PART NO.	DESCRIPTION OF PART
	17	32-40-1241 Intermediate Gear
	18	02-04-0640 Ball Bearing
	19	36-66-2801 Intermediate Pinion Shaft
(2)	20	36-66-2401 Intermediate Pinion Shaft
(2)	21	48-66-3280 Chuck Key
(2)	22	48-66-1360 Chuck (1/2-20 Thread 3-Jaw)
	23	42-52-0071 Bearing Cap
	24	02-04-1560 Ball Bearing
	25	38-50-3651 Spindle
	26	32-75-1861 Spindle Gear
	27	32-75-2041 Spindle Gear
	28	28-14-0961 Gear Case
	29	02-50-2110 Needle Bearing

### MISCELLANEOUS PARTS NOT SHOWN

PART NO.	DESCRIPTION OF PART	PART NO.	DESCRIPTION OF PART	QUANTITY	
43-62-0160	Handle	06-81-6150	8-32x1/2" Fil. Hd. Sems Cord Clamp Strap Screws	(2)	
44-90-0130	Handle Ring	06-81-8625	6-32x1/4" Rd. Hd. Ground Screw (Brass)		
06-42-0800	Woodruff Keys	06-81-6350	8-32x1 Fil. Hd. Sems Gear Case Screws		
06-81-8400	4-40x1/4 Rd. Hd. Name Plate Screws	(3)	06-81-6650	8-32x1 1/2 Fil. Hd. Sems Gear Case Screws	(2)
06-81-5790	6-32x1/4 Fil. Hd. Sw. Mtg. Sems	(2)	06-81-6600	8-32x1 1/2 Fil. Hd. Sems Field Screws	(2)
23-86-0110	Brush Holder Insul. Washer	(2)	06-83-2650	1/4-20x3/8 Hd'less Brush Holder Set Screws	(2)
06-75-3150	1/4-20x1 L.H. Allen Hd Rev. Chuck Scr.	(2)	06-81-3700	8-32x7/8 Oval. Hd. Handle Cover Screws	(4)
48-03-0010	Attachment Plug Adaptor	0	45-36-0210	Gear Spacer	