



BOSCH

Diamond Drilling Machine

1 189 EVSW | 0 601 189 739

Table of Content

| | |
|--------------------------|---|
| Spare parts list..... | 2 |
| Illustration - Type..... | 6 |

Spare parts list

| Item | Part Number | Description | Illustration |
|-------------|--------------------|---|---------------------|
| 3/50 | 3 606 610 002 | Fan | 1 |
| 4 | 3 607 200 084 | Switch | 1 |
| 4/10 | 2 910 011 082 | Socket head cap screw DIN 84-AM3,5x6-5.8 | 1 |
| 6 | 3 600 703 011 | Grommet Ø9,2-Ø12x120 MM | 1 |
| 7 | 1 601 302 013 | Fastening Clamp | 1 |
| 9 | 2 610 994 189 | Manufacturer's nameplate | 1 |
| 9/1 | 2 610 994 190 | Reference Plate SHADOW SIDE | 1 |
| 9/3 | 2 610 994 199 | Reference Plate | 1 |
| 13 | 2 600 905 032 | Ball Bearing 7x19x6 | 1 |
| 14 | 3 600 905 131 | groove ball bearing 9x26x8 | 1 |
| 16 | 3 604 336 012 | Brush Holder | 1 |
| 17 | 1 607 233 127 | Speed governor 100-120V | 1 |
| 18 | 3 600 460 006 | Segmented Ring | 1 |
| 19 | 3 605 500 153 | Cover | 1 |
| 20 | 1 603 435 061 | Tapping Screw TORX-T20 | 1 |
| 21 | 1 604 613 006 | Compression Spring | 1 |
| 23 | 3 605 500 063 | Sealing cap BLUE | 1 |
| 24 | 2 910 211 019 | Tapping Screw DIN 7971-ST3,9x16-F | 1 |
| 25 | 2 910 021 118 | Socket head cap screw DIN 84-AM4x8-8.8 | 1 |
| 26 | 1 600 502 011 | Intermediate Ring | 1 |
| 28 | 3 606 135 006 | Drilling Spindle | 1 |
| 29 | 3 600 283 042 | Rotary shaft lip seal 17X32X7 | 1 |
| 30 | 1 600 300 090 | Intermediate Ring | 1 |
| 32 | 3 605 500 156 | Bearing cover | 1 |
| 33 | 2 910 211 018 | Tapping Screw DIN 7971-ST3,9x13-F | 1 |
| 34 | 3 600 499 016 | Air-Deflector Ring | 1 |
| 35 | 3 601 025 003 | Wire Guide | 1 |
| 36 | 3 603 435 024 | Lens Head Screw | 1 |
| 38 | 3 604 652 001 | Spiral Spring | 1 |
| 39 | 2 910 211 239 | Tapping Screw DIN 79-4,8x45-C-ST | 1 |
| 40 | 3 604 411 040 | Thread-forming tap. Screw | 1 |
| 44 | 3 604 438 031 | Connecting Cable | 1 |
| 45 | 3 604 414 049 | Earth Conductor L=415 MM | 1 |
| 47 | 1 604 477 001 | Blade terminal | 1 |
| 48 | 3 603 231 008 | Rotary Knob | 1 |

Spare parts list

| Item | Part Number | Description | Illustration |
|-------------|--------------------|--|---------------------|
| 50 | 2 917 550 099 | Straight Pin DIN 6325-4m6x20 | 1 |
| 51 | 1 903 230 013 | Ball DIN 5401-Ø7MM-III-ST | 1 |
| 52 | 2 600 910 001 | Needle-Roller Bearing Ø14 MM | 1 |
| 54 | 1 600 910 018 | Needle bearing Ø8xØ12x8 MM | 1 |
| 55 | 1 600 100 617 | Shim 0,5 MM THICK | 1 |
| 57 | 3 600 100 083 | Shim | 1 |
| 59 | 1 610 910 088 | Needle bearing | 1 |
| 61 | 3 606 317 047 | Cylindrical Gear Z=34 | 1 |
| 62 | 3 606 317 048 | Cylindrical Gear Z=45 | 1 |
| 63 | 3 602 317 037 | Wedge | 1 |
| 64 | 3 604 610 048 | Compression Spring | 1 |
| 65 | 3 601 015 009 | Seal | 1 |
| 66 | 3 600 101 051 | Carrier | 1 |
| 67 | 3 602 317 050 | Guide Key | 1 |
| 68 | 3 604 610 049 | Compression Spring | 1 |
| 69 | 2 917 800 032 | Coiled Spring Pin DIN 7343-4x2 | 1 |
| 71 | 2 917 500 121 | Straight Pin 5 H 8x18 DIN 7 | 1 |
| 72 | 1 900 900 273 | groove ball bearing 6003 Y DIN 625 | 1 |
| 73 | 2 916 650 008 | Spring retaining ring DIN 471 17x1 MM | 1 |
| 77 | 2 600 590 006 | Ratchet Cap | 1 |
| 87 | 3 600 210 028 | O-Ring 6,0x2,0 MM | 1 |
| 88 | 3 600 210 115 | O-Ring 12,5x2,5 MM | 1 |
| 92 | 3 600 707 022 | Shrinkable Tube | 1 |
| 93 | 3 600 400 028 | Spacer Sleeve | 1 |
| 94 | 3 600 400 025 | Plain Washer | 1 |
| 95 | 3 600 400 026 | Spacer Sleeve | 1 |
| 96 | 3 603 414 022 | Socket head cap screw M4x103 MM | 1 |
| 97 | 3 601 016 003 | Contact Sheet | 1 |
| 98 | 3 603 100 033 | Bolt | 1 |
| 99 | 2 916 031 006 | Toothed lock washer | 1 |
| 100 | 3 603 100 034 | Threaded Insert | 1 |
| 101 | 3 602 319 041 | Socket-Terminal Strip 1x1,5 MM | 1 |
| 102 | 3 601 119 070 | Reference Plate | 1 |
| 801 | 3 605 108 181 | Motor Housing BLUE | 1 |
| 802 | 3 604 220 108 | Field 110-120V | 1 |

Diamond Drilling Machine | 1 189 EVSW | 0 601 189 739

Spare parts list

| Item | Part Number | Description | Illustration |
|------|---------------|---|--------------|
| 803 | 3 604 010 090 | Armature 110-120V | 1 |
| 805 | 3 604 460 114 | Power supply cord | 1 |
| 805 | 3 604 460 158 | Power supply cord | 1 |
| 806 | 3 604 477 009 | End Splice | 1 |
| 808 | 1 601 11A 3H7 | Nameplate | 1 |
| 810 | 3 607 014 005 | Carbon-Brush Set | 1 |
| 818 | 3 600 460 005 | Segmented Ring | 1 |
| 822 | 3 605 806 184 | Spindle Bearing | 1 |
| 827 | 3 605 133 022 | Handle | 1 |
| 831 | 3 600 290 070 | Rotary shaft lip seal | 1 |
| 837 | 3 607 030 438 | Intermediate Bearing | 1 |
| 841 | 3 602 329 036 | Holding Plate | 1 |
| 844 | 3 604 438 017 | Connecting Cable L=330 MM GRAY | 1 |
| 846 | 3 604 441 010 | Connecting Cable L=170 MM WHITE | 1 |
| 851 | 2 916 060 005 | Spring Washer DIN 137-A 4-ST | 1 |
| 856 | 3 606 309 054 | Spur Wheel Clutch | 1 |
| 890 | 1 601 030 022 | Tab Washer | 1 |
| 201 | 3 605 500 152 | Protective Cap | 2 |
| 202 | 3 600 224 046 | Retaining ring | 2 |
| 204 | 3 600 400 023 | Sleeve | 2 |
| 205 | 3 600 100 079 | Retaining Washer | 2 |
| 206 | 3 600 905 114 | groove ball bearing 30x47x9 | 2 |
| 207 | 3 606 319 030 | Carrier | 2 |
| 208 | 3 603 130 004 | Hollow Shaft | 2 |
| 209 | 3 604 610 155 | Compression Spring | 2 |
| 212 | 2 916 650 017 | Spring retaining ring DIN 471 30x1,5 MM | 2 |
| 213 | 3 600 224 050 | Retaining ring | 2 |
| 214 | 3 600 109 013 | Sealing disk | 2 |
| 215 | 3 604 610 053 | Compression Spring | 2 |
| 216 | 3 600 300 056 | Stop Ring | 2 |
| 217 | 3 600 113 021 | Driver Disc | 2 |
| 218 | 3 600 224 051 | Retaining ring | 2 |
| 219 | 3 600 224 047 | Retaining ring | 2 |
| 220 | 3 600 283 041 | Rotary shaft lip seal 30X42X6 | 2 |
| 221 | 3 600 190 021 | Supporting Disc | 2 |

Spare parts list

| Item | Part Number | Description | Illustration |
|-------------|--------------------|------------------------------------|---------------------|
| 224 | 3 603 100 037 | Retaining Pin | 2 |
| 225 | 3 605 102 084 | Housing | 2 |
| 226 | 3 600 700 053 | Sight Glass | 2 |
| 227 | 3 605 510 041 | Impeller Wheel | 2 |
| 228 | 3 600 210 112 | O-Ring 25,0x2,65 MM | 2 |
| 229 | 3 600 210 114 | O-Ring 33,0x2,5 MM | 2 |
| 230 | 3 600 100 082 | Plain Washer | 2 |
| 231 | 3 602 380 011 | Isolating Valve | 2 |
| 232 | 3 600 760 107 | Flexible Connection | 2 |
| 232/60 | 1 609 351 000 | O-Ring 11x2,5 MM | 2 |
| 234 | 3 603 386 050 | Hose Coupling 1/2" | 2 |
| 235 | 2 917 550 077 | Straight Pin DIN 6325-3M6x12 | 2 |
| 236 | 3 603 386 057 | Self-locking nut M5 | 2 |
| 237 | 3 600 109 014 | Sealing Disc | 2 |
| 238 | 3 600 224 056 | Spring retaining ring | 2 |
| 240 | 3 600 300 057 | Retaining snap ring | 2 |
| 651 | 3 602 025 014 | Auxiliary Handle M14 BLACK | 2 |
| 654 | 1 615 438 373 | Carrying Case | 2 |
| 715 | 2 608 598 112 | Lengthening Piece SDS-DI, L=300 MM | 2 |
| 725 | 2 609 390 317 | Flushing Jet SDS-DI | 2 |
| 725/1 | 2 609 390 318 | Extractor Head SDS-DI | 2 |
| 726 | 0 601 190 026 | Drill Stand | 2 |
| 727 | 2 609 390 313 | pilot drilling guide | 2 |
| 758 | 2 609 390 308 | Calibrating Unit | 2 |
| 759 | 2 609 390 315 | Sharpening Stone | 2 |
| 760 | 1 609 202 230 | Air Hose Ø 35 MM, L=5 M | 2 |
| 761 | 0 601 989 139 | All Purpose Vacuum Clean | 2 |
| 811 | 3 603 349 003 | Star Knob | 2 |
| 820/03 | 3 602 319 043 | Fastener | 2 |
| 823 | 3 600 300 055 | Clamp Bushing | 2 |

Illustration - Type - E

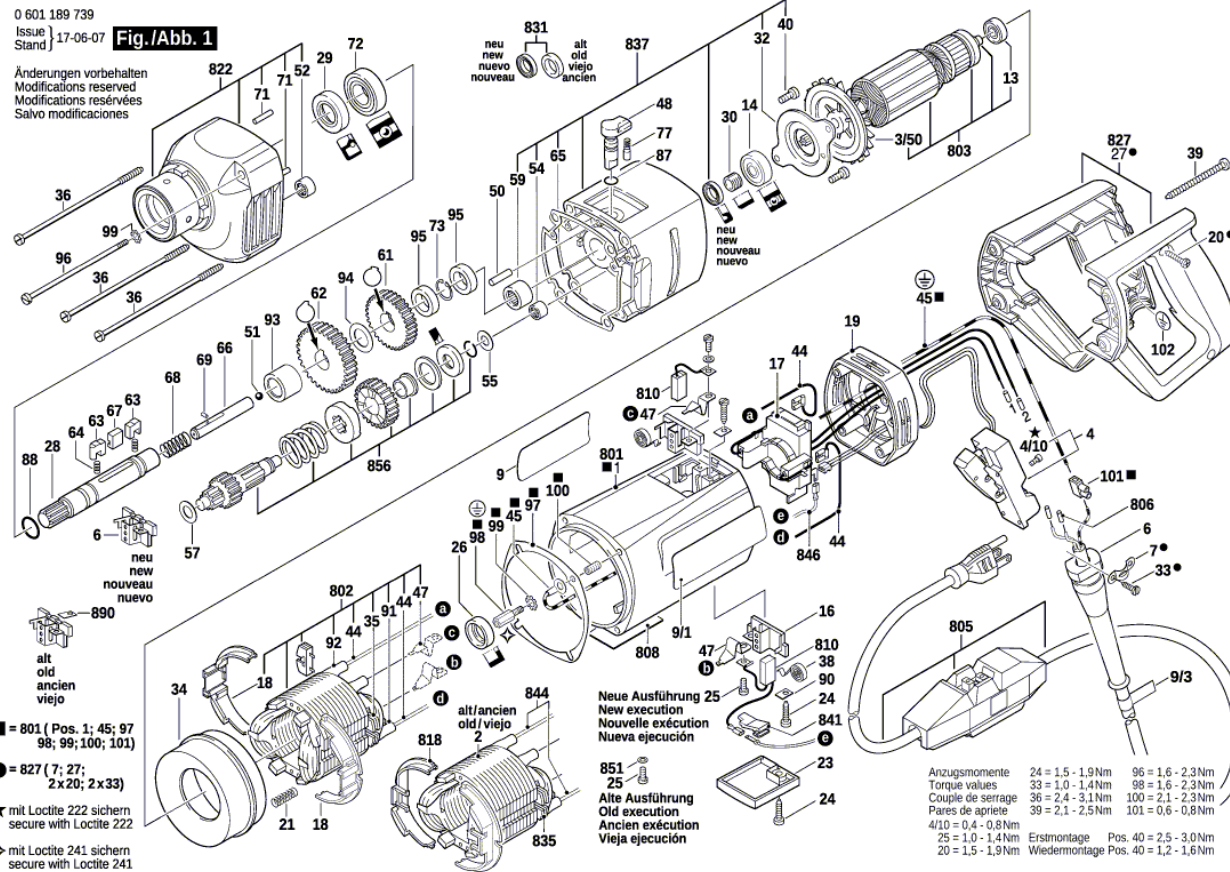

Illustration - Type - E

