



# SERVICE PARTS LIST

BUL. 54-08-2101

1/2" ELECTRIC DRILL

REVISED BUL  
614-4

DATE  
FEB. '68

Catalog No. 1100

Starting Serial No. 14-23001

WIRING INSTR.

Both Model and Serial No. must be furnished to obtain correct parts.

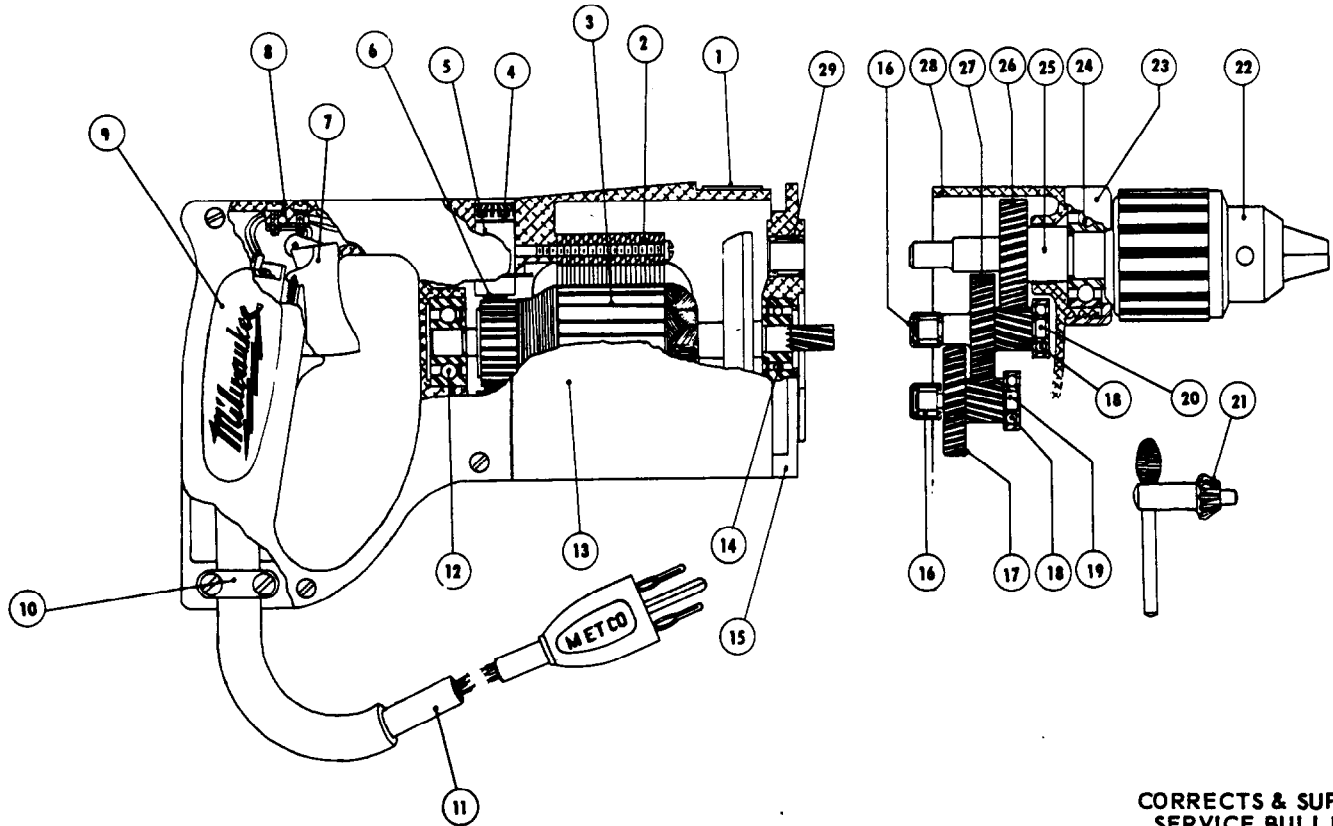

CORRECTS & SUPERCEDES:  
SERVICE BULLETIN 614-  
DATED 12/24/57

FIG.	PART NO.	DESCRIPTION OF PART
1	12-98-0800	Name Plate
2	18-42-1040	Field Assembly
3	16-42-1210	Armature with Fan
4	23-44-0060	Brush Retaining Screw
5	22-22-0080	Brush Holder Assembly
6	22-18-0100	Carbon Brush Assembly
7	23-66-0230	Switch
8	45-36-0110	Switch Spacer
9	28-20-3141	Handle Cover
10	28-17-0400	Cord Clamp Strap
11	22-64-0170	Cord Set
12	02-04-0970	Ball Bearing
13	28-50-4481	Motor Housing
14	02-04-0940	Ball Bearing
15	28-28-0661	Diaphragm

ILLUSTRATED PARTS

FIG.	PART NO.	DESCRIPTION OF PART
16	02-50-1640	Needle Bearing
17	32-40-1241	Intermediate Gear
18	02-04-0640	Ball Bearing
(2)	19	36-66-2801 Intermediate Pinion Shaft
(2)	20	36-66-2901 Intermediate Pinion Shaft
(2)	21	48-66-3280 Chuck Key
22	48-66-1280	Chuck (1/2-20 Thr'd 3-Jaw)
23	42-52-0071	Bearing Cap
24	02-04-1560	Ball Bearing
25	38-50-3601	Spindle
26	32-75-2061	Spindle Gear
27	32-75-2041	Spindle Gear
28	28-14-0961	Gear Case
29	02-50-2110	Needle Bearing

MISCELLANEOUS PARTS NOT SHOWN

PART NO.	DESCRIPTION OF PART
45-36-0210	Spacer
43-62-0161	Handle
44-90-0130	Handle Ring
06-42-0800	Woodruff Keys (3)
06-81-8400	4-40x1/4 Rd.Hd. Name Plate Scs. (Sems)(2)
06-81-5800	6-32x5/16 Fil.Hd.Sems Switch Mtg. Scs. (2)
23-86-0110	Brush Holder Insulating Washer (2)
23-16-0085	Switch Insulator
06-81-6100	8-32x7/16 Fil. Hd. Cord Clamp Strap Scs. (Sems)(2)
06-81-8625	6-32x1/4 Rd. Hd. Ground Screw (Brass) (Sema)
06-81-6350	8-32x1 Fil. Hd. Gear Case Screws (Sem)
06-81-6650	8-32x1-3/4 Fil. Hd. Gear Case Scs. (Sem)
06-81-6600	8-32x1-3/4 Fil. Hd. Field Screws (Sem)
06-83-2650	1/4-20x3/8 Hd'less Brush Holder Set Screws (2)
06-81-3700	8-32x7/8 Oval Hd. Handle Cover Screws (4)
48-03-0010	Attachment Plug Adaptor

Numbers in brackets indicate number required.