



# SERVICE PARTS LIST

BUL. 54-08-1071

1/2" ELECTRIC DRILL

REVISED BUL. 6126-2 DATE FEB. '68

Catalog No. 1000-1

Starting Serial No. 126-4861

WIRING INSTR.

Both Model and Serial No. must be furnished to obtain correct parts.

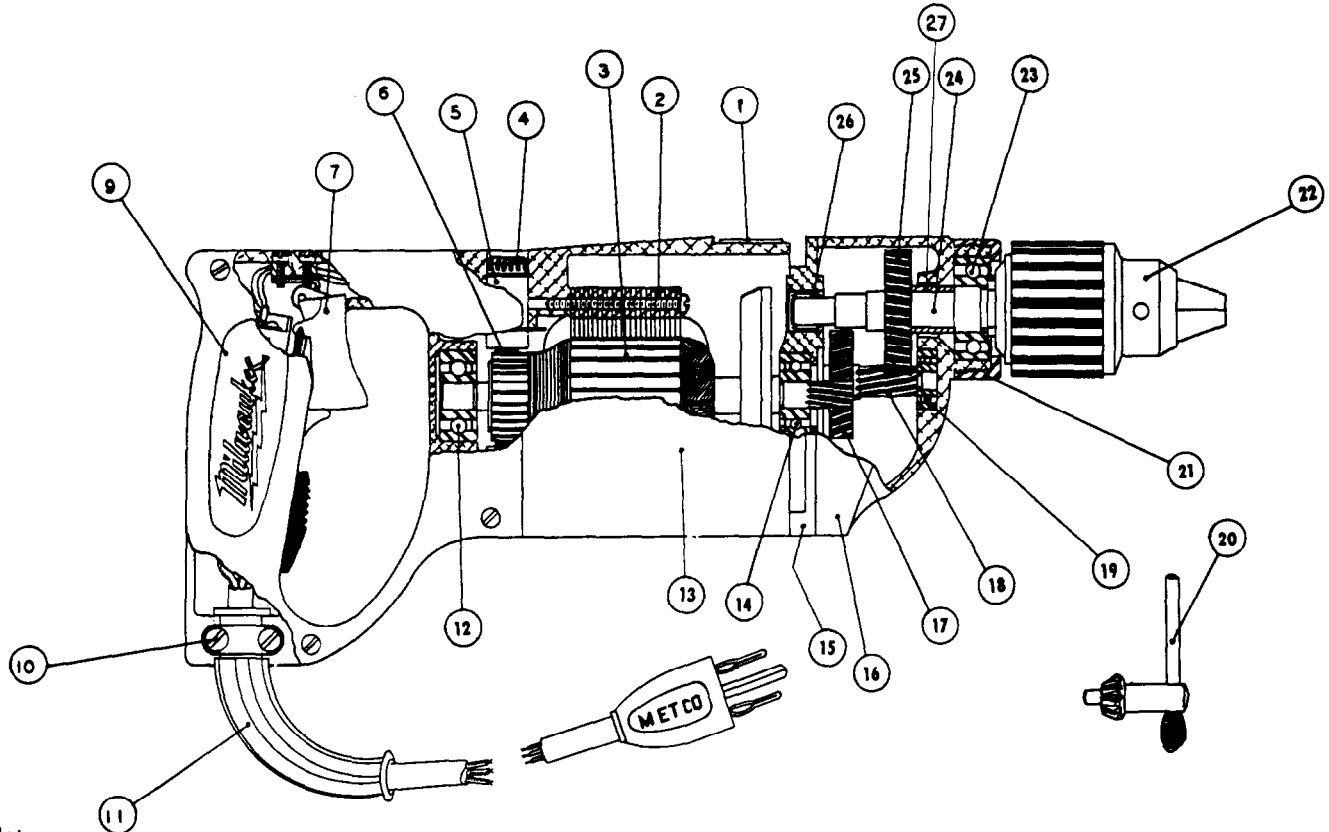

230V Motor  
16-46-1190 Armature  
18-46-1041 Field

FIG. PART NO.		DESCRIPTION OF PART	ILLUSTRATED PARTS		FIG. PART NO.	DESCRIPTION OF PART
1	12-98-0800	Name Plate	16	28-14-0681	16	Gear Case
2	18-42-1041	Field Assembly	17	32-40-1241	17	Intermediate Gear
3	16-42-1210	Armature Assembly	18	36-66-2001	18	Intermediate Pinion
4	23-44-0060	Brush Retaining Screw	19	02-04-0640	19	Inter. Shaft Ball Bearing
5	22-22-0080	Brush Holder Assembly	(2)	48-66-3280	20	Chuck Key
6	22-18-0100	Carbon Brush Assembly	(2)	42-52-0071	21	Bearing Cap
7	23-66-0440	Switch	(2)	48-66-1360	22	1/2" Chuck
9	28-20-3141	Handle Cover	23	02-04-1560	23	Ball Bearing
10	28-17-0400	Cord Clamp Strap	24	38-50-3651	24	Spindle
11	22-64-0170	Cord Set	25	32-75-1601	25	Spindle Gear
12	02-04-0970	Ball Bearing (Comm. End)	26	02-50-2110	26	Needle Bearing
13	28-50-4488	Motor Housing	27	45-36-0210	27	Spindle Gear Spacer
14	02-04-0940	Ball Bearing (Pinion End)				
15	28-28-0581	Diaphragm				

MISCELLANEOUS PARTS NOT SHOWN

SIZE OR PART NO.	DESCRIPTION OF PART	SIZE OR PART NO.	DESCRIPTION OF PART
02-50-1640	Needle Bearing	06-81-6100	8-32x1/2 Fil. Hd. Sems Cord Clamp Strap Scs. (2)
43-62-0160	Handle	06-81-8625	6-32x1/4 Rd. Hd. Sems Ground Screw (Brass)
44-90-0130	Handle Ring	06-81-6350	8-32x1 Fil. Hd. Sems Gear Case Screws
06-42-1200	Woodruff Keys (3)	06-81-6650	8-32x1 1/4 Fil. Hd. Sems Gear Case Screws (2)
06-81-8400	4-40x1/4 Rd. Hd. Name Pl. Scs. Sems (2)	06-81-6600	8-32x1 1/4 Fil. Hd. Sems Field Screws (2)
06-81-5790	6-32x1/4 Fil. Hd. Sw. Mtg. Sems (2)	06-83-2650	1/4-20x3/8 Hd'less Brush Holder Set Screws (2)
23-86-0110	Brush Holder Insul. Washer (2)	06-81-3700	8-32x7/8 Oval Hd. Handle Cover Screws (4)
48-03-0010	Attach. Plug Adaptor	06-75-3150	1/4-20x1 Left Hd. Allen Hd. Cap Sc. (Chuck Ret. Sc.)

Numbers in brackets indicate number required.