



SERVICE PARTS LIST

BUL. 54-08-0202

1/4" ELECTRIC DRILL

REVISED BUL 610-3 DATE FEB. '68

Catalog No. 0800

Starting Serial No. **10-3501**

WIRING INSTR.

Both Model and Serial No. must be furnished to obtain correct parts.

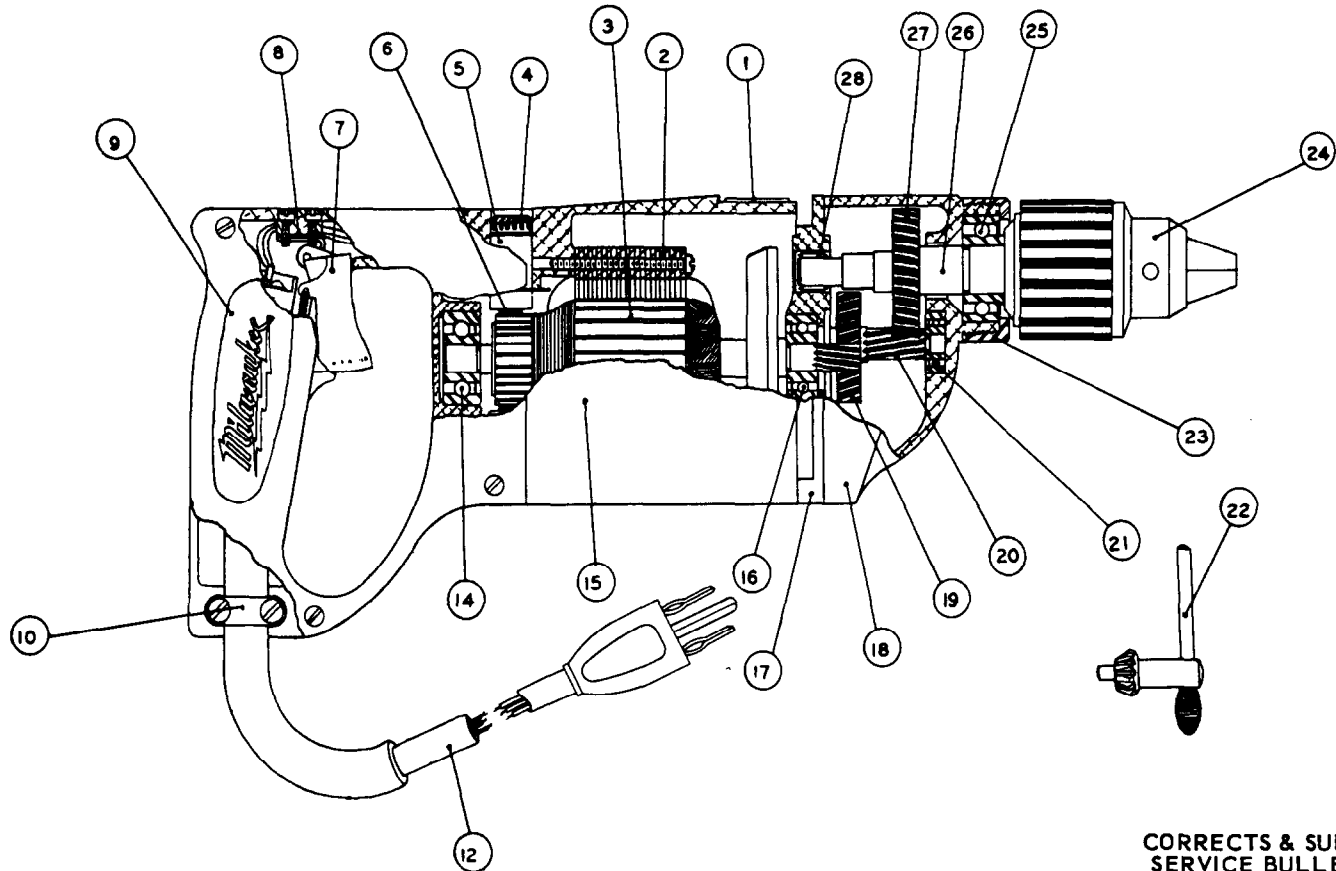

CORRECTS & SUPERCEDE SERVICE BULLETIN 610-3 DATED 10/15/58

FIG.	PART NO.	DESCRIPTION OF PART
1	12-98-0800	Name Plate
2	18-42-1040	Field Assembly
3	16-42-1040	Armature Assembly
4	23-44-0060	Brush Retaining Screw (2)
5	22-22-0080	Brush Holder Assembly (2)
6	22-18-0100	Carbon Brush Assembly (2)
7	23-66-0230	Switch
8	45-36-0110	Switch Spacer
9	28-20-3141	Handle Cover
10	28-17-0400	Cord Clamp Strap
12	22-64-0170	Cord Set
14	02-04-0970	Ball Bearing (Comm. End)
15	28-50-4481	Motor Housing

ILLUSTRATED PARTS

FIG.	PART NO.	DESCRIPTION OF PART
16	02-04-0940	Ball Bearing (Pinion End)
17	28-28-0581	Diaphragm
18	28-14-0681	Gear Case
19	32-40-1241	Intermediate Gear
20	36-66-2451	Intermediate Pinion Shaft
21	02-04-0640	Ball Bearing
22	48-66-3200	Chuck Key
23	42-52-0071	Bearing Cap
24	48-66-0300	Chuck (1/2" - 20 Thread)
25	02-04-1560	Ball Bearing
26	38-50-2551	Spindle
27	32-75-1881	Spindle Gear
28	02-50-2110	Needle Bearing

MISCELLANEOUS PARTS NOT SHOWN

PART NO.	DESCRIPTION OF PART	PART NO.	DESCRIPTION OF PART
02-50-1640	Needle Bearing	06-81-6150	8-32x1/2" Fil.Hd. Sems Cord Clamp Strap Scs.
43-62-0161	Handle	06-81-8685	6-32x1/4" Rd.Hd. Sems Ground Screw (Brass)
44-90-0130	Handle Ring	06-81-6350	8-32x1" Fil. Hd. Gear Case Screws (Sem)
06-42-0800	Woodruff Keys (3)	06-81-6650	8-32x1-3/4 Fil.Hd. Gear Case Screws (Sem)
06-81-8400	4-40x1/4" Rd.Hd. Name Plate Scs. Sems (2)	06-81-6600	8-32x1-3/4 Fil.Hd. Field Screws (Sems)
06-81-5800	6-32x5/16" Fil.Hd. Sems Switch Mtg. Scs. (2)	06-83-2650	1/4-20x3/8 Hd'less Brush Holder Set Screws
23-86-0110	Brush Holder Insul. Washer (2)	06-81-3700	8-32x7/8" Oval Hd. Handle Cover Screws
23-16-0085	Switch Insulator	48-03-0010	Attachment Plug Adaptor

Numbers in brackets indicate number required.