



BOSCH

Un. 2-Speed Drill

---- | 0 601 121 039

Table of Content

Spare parts list.....	2
Illustration - Type.....	5

Spare parts list

Item	Part Number	Description	Illustration
1	3 605 108 113	Motor Housing	1
2	1 604 220 204	Pole Shoe 115V	1
2/20	1 901 350 003	Terminal lug 1,5-4x4	1
3	1 604 010 201	Armature With Fan 115V	1
4	2 600 905 032	Ball Bearing 7x19x6	1
5	1 600 502 011	Intermediate Ring	1
6	1 604 336 017	Brush Holder	1
7	1 601 030 022	Tab Washer	1
8	1 604 652 006	Spiral Spring	1
11	1 605 500 089	Sealing cap BLUE	1
12	1 607 328 024	Suppression Filter	1
12/20	1 601 353 003	Terminal lug	1
13	1 601 110 058	Reference Plate DOUBLE INSULATION	1
15	3 605 500 058	Sealing cap BLUE	1
16	3 605 500 059	Sealing cap BLUE	1
17	3 605 133 010	Handle DARK BLUE	1
18	3 605 132 027	Handle BLUE	1
19	3 600 703 011	Grommet Ø9,2-Ø12x120 MM	1
20	1 604 460 024	Power supply cord	1
21	1 601 302 014	Fastening Clamp	1
22	1 607 200 078	Switch	1
23	3 607 200 000	Switch	1
25	1 611 331 007	Tab Washer	1
26	1 900 452 003	End Splice DIN 46 228-A2,5-7	1
28	1 601 110 128	Sticker DOUBLE INSULATION	1
29	1 601 110 046	Sticker	1
30	1 600 502 016	Change-Over Switch	1
31	1 600 206 018	Intermediate Ring	1
32	1 600 905 003	groove ball bearing	1
33	2 916 603 018	Retaining ring 35 DIN 9045	1
34	1 600 500 023	Cover Disc	1
35	1 600 108 003	Felt Disc	1
36	1 600 202 034	Intermediate Ring	1
37	3 605 820 035	Intermediate Bearing	1
38	1 601 015 013	Sealing Plate	1

Spare parts list

Item	Part Number	Description	Illustration
39	1 606 309 066	Toothed Shaft Z=9	1
40	1 604 611 022	Compression Spring	1
41	1 903 230 009	Ball DIN 5401-5 G28	1
42	1 606 317 074	Cylindrical Gear Z=32	1
43	1 606 317 082	Cylindrical Gear Z=43	1
44	1 600 910 013	Needle bearing	1
45	1 606 309 064	Spindle With Gear Z=14/24/33	1
46	1 600 100 631	Shim 0,5 MM THICK	1
47	1 600 101 647	Shim 0,6 MM THICK	1
48	1 606 325 025	Control Shaft Z=20	1
49	1 601 038 025	Notched Plate	1
50	1 602 026 044	Control Lever	1
51	1 606 325 027	Control Shaft Z=10	1
52	1 900 210 105	O-Ring 8x2,5 MM	1
54	2 600 910 001	Needle-Roller Bearing Ø14 MM	1
55	1 605 806 382	Spindle Bearing	1
55/3	2 917 500 121	Straight Pin 5 H 8x18 DIN 7	1
56	1 606 135 017	Drilling Spindle	1
57	1 900 905 126	groove ball bearing 25x47x12	1
58	2 916 650 014	Spring retaining ring DIN 471 25x1,2	1
59	3 600 290 035	Seal Ring 20x31x7 MM	1
60	3 606 316 108	Cylindrical Gear	1
61	1 605 703 075	Fastening Flange	1
64	1 600 763 010	Handle 400 MM BLACK	1
66	1 604 412 061	Cable	1
67	1 603 435 013	Tapping Screw B4,8x72,5 MM	1
68	3 603 435 027	Tapping Screw 5x30	1
69	2 914 201 529	Torx Oval-Head Screw	1
71	1 603 435 015	Tapping Screw B4,8x115 MM	1
72	2 914 201 508	Torx Oval-Head Screw	1
73	2 910 211 011	Tapping Screw DIN 7971-BZ3,5x13	1
74	2 910 021 118	Socket head cap screw DIN 84-AM4x8-8.8	1
75	2 910 021 116	Socket head cap screw DIN 84-AM4x6-8.8	1
76	2 910 211 019	Tapping Screw DIN 7971-ST3,9x16-F	1
77	2 910 511 120	Dummy AM 4x10 DIN 63-8.8	1

Spare parts list

Item	Part Number	Description	Illustration
78	2 910 021 154	Socket head cap screw DIN 84-AM5x12-8.8	1
79	2 915 011 005	Hex Nut DIN 934 -M4-m-8	1
801	3 607 014 012	Carbon-Brush Set	1

Illustration - Type - E

Typ 0 601 121 039
060

Stand 81-05

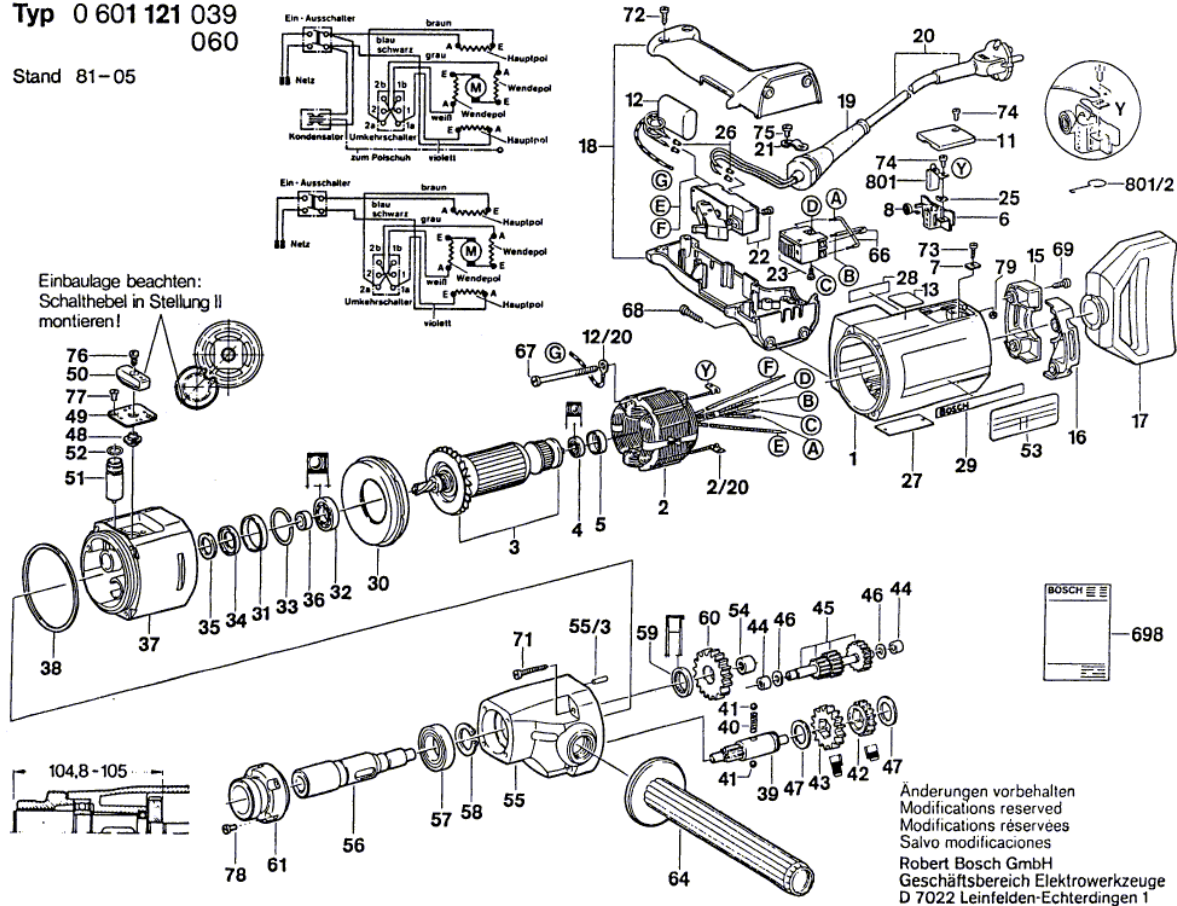

F4