



SERVICE PARTS LIST

BUL. 54-06-3151

1/4" PISTOL DRILL

Catalog No. **0290**

Starting Serial No. **81-1060**

REVISED BUL 681-2 DATE Feb. '68

WIRING INSTR. 58-01-0020

Both Model and Serial No. must be furnished to obtain correct parts.

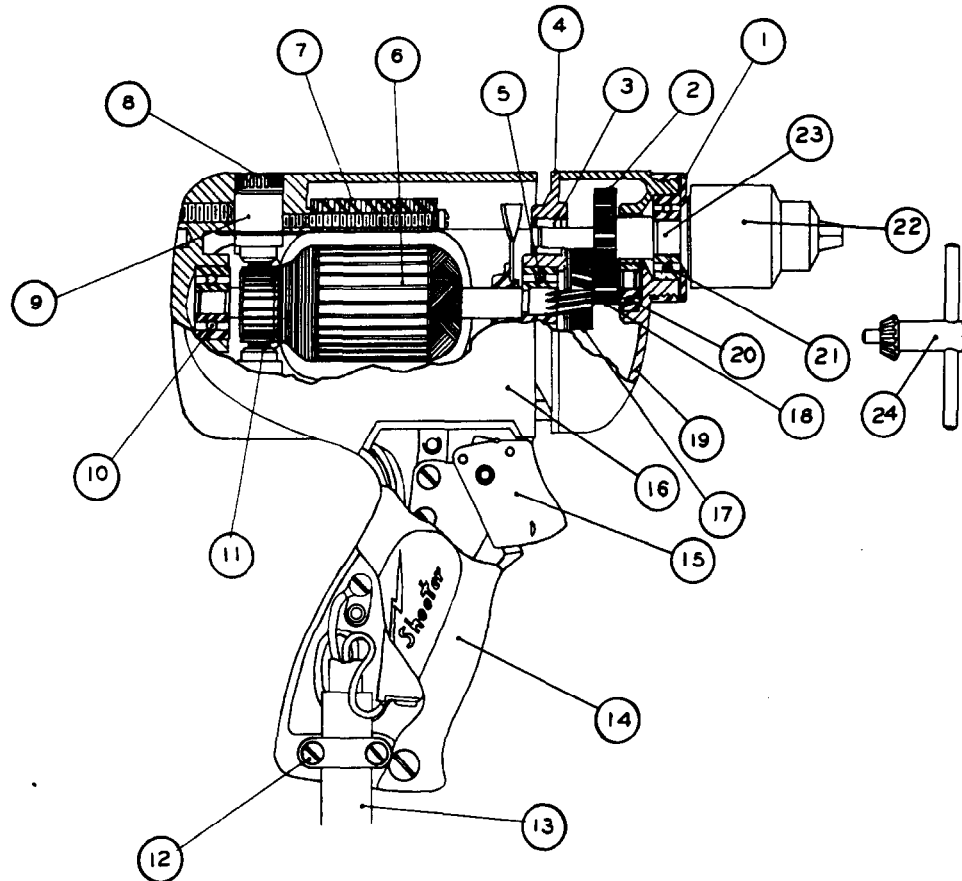

ILLUSTRATED PARTS

FIG.	PART NO.	DESCRIPTION OF PART	FIG.	PART NO.	DESCRIPTION OF PART	
1	42-52-0060	Bearing Cap	14	28-20-3171	Switch Cover Plate	
2	32-75-1281	Spindle Gear	15	23-66-0270	Switch	
3	02-50-1640	Needle Bearing	*16	28-50-4601	Motor Housing (Incl. item 14 & scrs.)	
4	28-28-0221	Diaphragm	17	32-40-1041	Intermediate Gear	
5	02-04-0880	Ball Brg. (Pinion End)	18	36-66-1351	Pinion Shaft	
6	16-22-1120	Armature Assembly	19	28-14-0361	Gear Case	
7	18-22-1030	Field Assembly	20	02-04-0640	Ball Bearing	
8	23-44-0020	Brush Retaining Cap	(2)	21	02-04-1020	Ball Bearing
9	22-22-0050	Brush Holder Assembly	(2)	22	48-66-0260	Chuck
10	02-04-0740	Ball Bearing	(2)	23	38-50-1051	Spindle
11	22-18-0090	Carbon Brush Assemblies	(2)	24	48-66-3200	Chuck Key
12	28-17-0400	Cord Clamp				
*13	22-64-0170	Cord Set				

MISCELLANEOUS PARTS NOT SHOWN

PART NO.	DESCRIPTION OF PART	PART NO.	DESCRIPTION OF PART
48-66-4080	Rubber Flex Chuck Key Holder	48-03-0010	Attachment Plug Adaptor
44-66-0110	Air Intake Cover Plates (2)	06-81-8625	6-32x1/4" Brass Rd.Hd. Ground Screw Sem
06-81-8650	6-32x1/4" Rd.Hd. Sems Ventilating Plate Scs (4)	06-81-6550	8-32x1 1/2" Fil. Hd. Gear Case Scs. Sems (2)
12-98-0600	Name Plate	06-81-6300	8-32x7/8" Fil.Hd.Sems Gear Case Screws (2)
06-81-4300	3-48x3/16" Rd.Hd. Name Plate Screws (2)	06-81-5950	6-32x1-7/8" Fil.HD. Field Screws Sems (2)
*06-81-0900	8-32x7/16 Fil.Hd. Cord Clamp Screw	06-81-5400	8-32x5/16" Binder Hd. Switch Mounting Scs. (2)
06-81-6100	8-32x7/16" Fil.Hd. Cord Clamp Screw Sems	06-81-3700	8-32x7/8" Oval Hd. Handle Cover Screws
06-42-0800	Woodruff Key (Spindle)	06-81-3650	8-32x3/4" Oval Hd.Handle Cover Scs.Top (2)
06-83-2670	1/4"-20x1/2" Hd'less Slotted Brush Holder Set Screws (2)	06-42-0400	Woodruff Key (Pinion Shaft)
		02-50-1210	Needle Bearing
		*06-97-1800	Switch Lock Washer (4)